

Dept	
Qty	
DC	1
ED	1
IE	1
ISO	1
PD	1
R&D	1
SD	1
QA	1
QC	1
QF	1

The information provided herein is from CONNELY Electronic Co., Ltd. and is confidential. Any disclosure to a party other than the recipient is prohibited. The intellectual properties and its rights contained herein, including but not limited to, trademarks, patents, copyrights, trade secrets, and technical know-how, are owned exclusively by CONNELY or its affiliates. Unauthorized use or reproduction of any part of this document is strictly prohibited. CONNELY may enforce its intellectual property rights at its own discretion, failures or delays to exercise such rights does not constitute a waiver of such rights.

R1 type

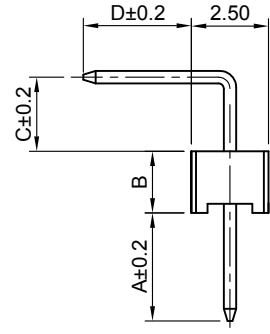
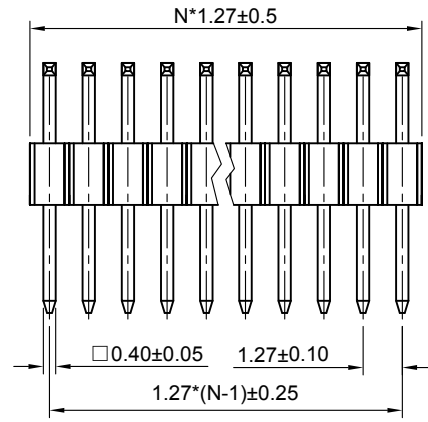

R2 type

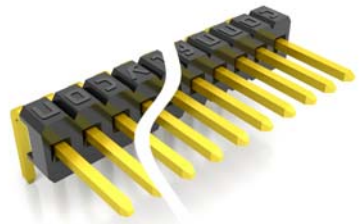
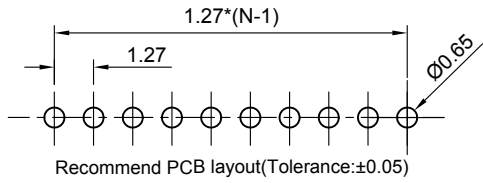
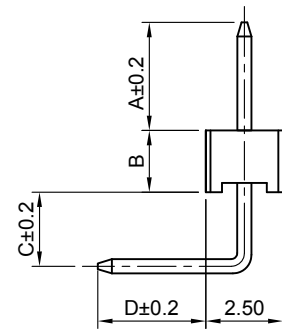
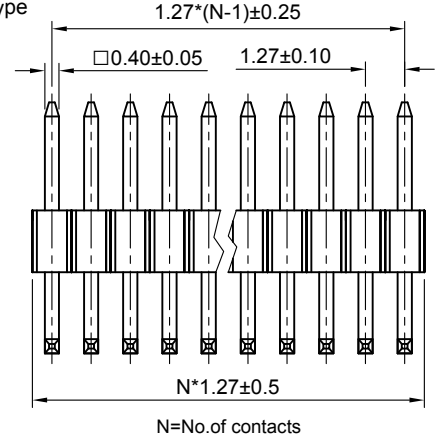

(Series Image-Reference Only)

Type	DIM A	DIM D	DIM C
1	3.50	3.50	2.40
2	8.80	3.50	1.80
3	2.60	3.20	1.50
4	3.50	2.40	1.00

GENERAL TOLERANCE		ANGLE TOLERANCE	
X.	±0.60	X.	±5°
.X	±0.38	.X	±3°
.XX	±0.25	.XX	±2°
DRAWING TYPE		CUSTOMER	
SCALE		1:1	SHEET 1 OF 1
DRAWING NO.		C-DS1031-02-XXXXXXX-X-D	

REV.	DESCRIPTION	DRAWN	CHECKED	APPROVED
A	NEW RELEASE	YCH 06/20/08'		LJC 06/20/08'
D	DRAWING UPDATE	JLZ 07/16/20'		

NOTES:

- Material
 - Insulator:PA-9T(UL 94V-0).
 - Contact material:Copper alloy.
- Specification
 - Current rating:1.0 Amp.
 - Insulation resistance:500MΩ Min.
 - Dielectric withstanding:300VAC.
 - Contact resistance:50mΩ Max.
 - Operating temperature:-40°C TO+105°C.
- Product number code:

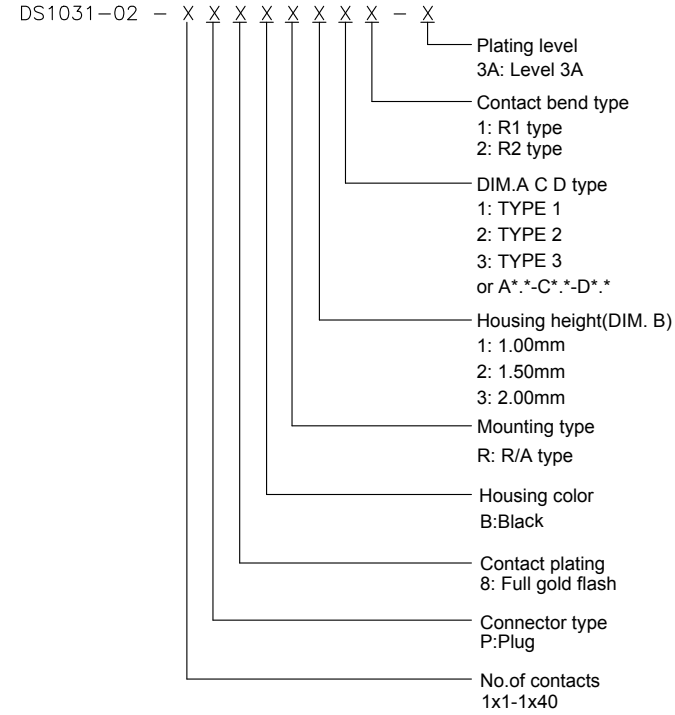

PROJECTION		TITLE	1.27mm Pin Header
UNITS	mm	Single R/A Type	
SHEET SIZE	A4	SERIES	DS1031-02 SERIES

晨翔电子有限公司
CONNFLY CONNFLY ELECTRONIC CO. LTD