

Dept	Qty
DC	1
ED	1
IE	1
ISO	1
PD	1
R&D	1
SD	1
QA	1
QC	1
QF	1

The information provided herein is from CONNELY Electronic Co., Ltd. and is confidential. Any disclosure to a party other than the recipient is prohibited. The intellectual properties and its rights contained herein, including but not limited to, trademarks, patents, copyrights, trade secrets, and technical know-how, are owned exclusively by CONNELY or its affiliates. Unauthorized use or reproduction of any part of this document is strictly prohibited. CONNELY may enforce its intellectual property rights at its own discretion, failures or delays to exercise such rights does not constitute a waiver of such rights.

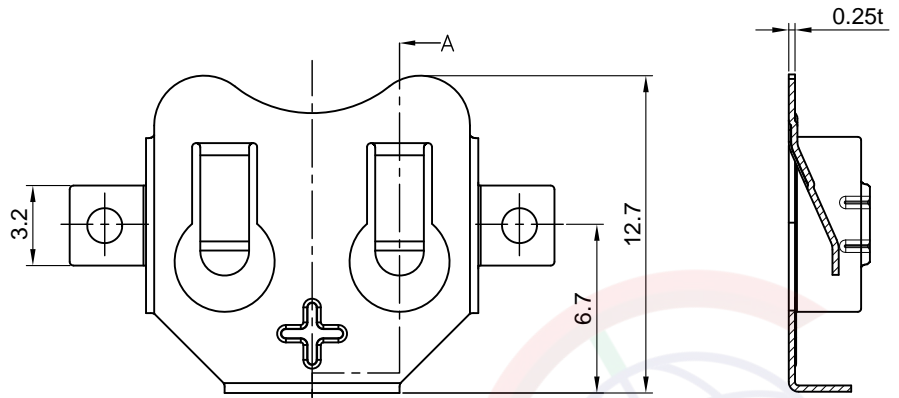

Section A-A

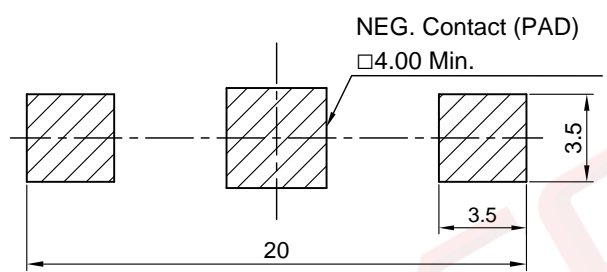
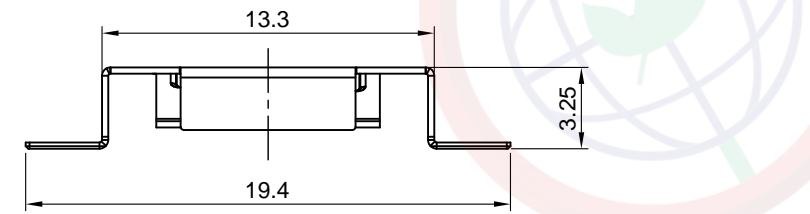

Mounting PAD layout



(Series Image-Reference Only)

REV.	DESCRIPTION	DRAWN	CHECKED	APPROVED
A	NEW RELEASE	JLZ 11/17/15'	HZW 11/17/15'	LJC 11/17/15'
B	DRAWING UPDATE	JLZ 10/18/19'		

NOTE:

1. Material: Phosphor bronze.
2. Part Number Code:

DS1092-20 - X X X X

- Picking type:
 - R: Tape on reel
 - P: Ploybag
- Contact plating:
 - N: Nickel
- Thickness:
 - 0250: 0.25mm
- Material:
 - PB: Phosphor bronze

GENERAL TOLERANCE		ANGLE TOLERANCE		PROJECTION		TITLE	
X.	±0.60	X.	±5°	UNITS	mm	CR1220~1225 Battery Holder	
.X	±0.38	.X	±3°	SHEET SIZE	A4	SERIES	DS1092-20 SERIES
.XX	±0.25	.XX	±2°	晨翔电子有限公司 CONNELY ELECTRONIC CO. LTD			
DRAWING TYPE		CUSTOMER					
SCALE		1:1					
DRAWING NO.		C-DS1092-20-XXXX-B					